

Veterans Memorial Tennis Center

SE 3 Courts - Reconstruction

City of Cedar Rapids, Iowa

Contract No. 311185-01

Utility & Emergency Numbers	
Parks & Recreation Department	319-286-5750
Police Department	319-286-5491
Fire Department	319-286-5200
Emergency	911
Alliant Energy	319-786-1912
Mid American Energy	319-298-5155
Water Department	319-286-5910
Qwest Communications	319-399-7600

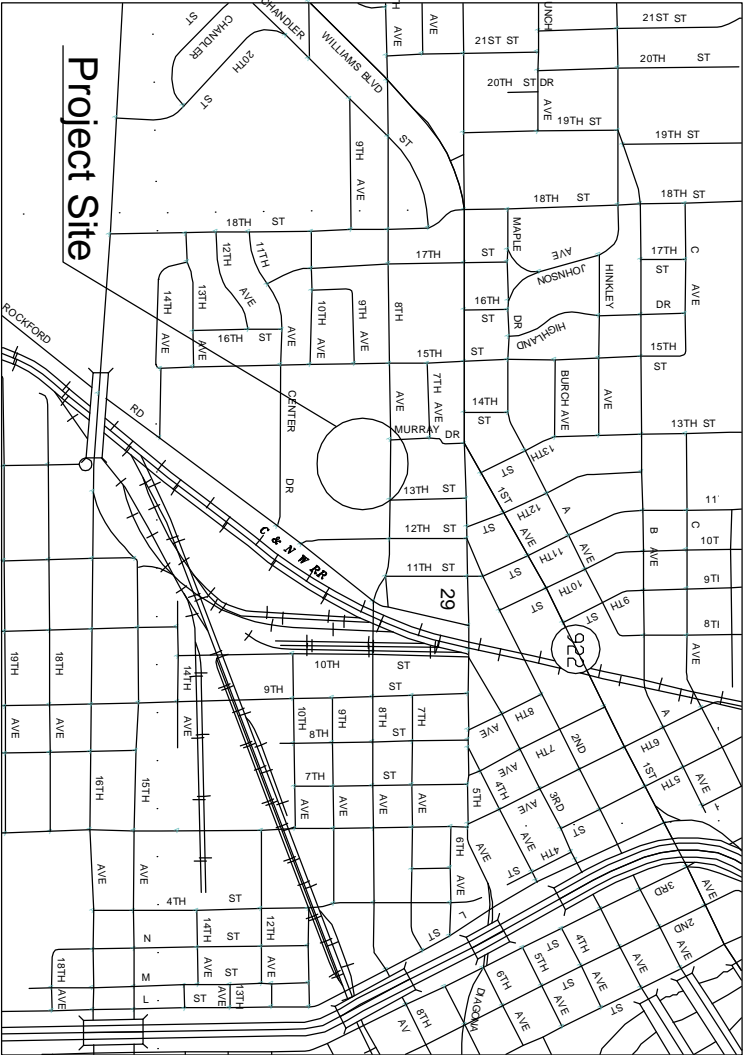

Location Map

Not to Scale

Cedar Rapids Metropolitan Specifications

Sections most prevalent to this project	
Section 01400	Clearing and Demolition
Section 02000	Grading and Excavation
Section 02100	Subgrade and Sub base Preparation
Section 02700	Portland Cement Concrete Pavement
Section 02750	Hot Mix Asphalt Pavement
Section 02800	Miscellaneous Pavement Construction
Section 02900	Seeding

Mayor: Ron Corbett
City Council

Susie Weinacht Ann Poe
Ralph Russell Kris Gulick
Scott Overland Pat Shey
Scott Olson Justin Shields

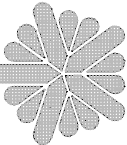

CEDAR RAPIDS
City Of Five Seasons

Sheet Index	
Cover Sheet	
1-2 Demolition / Removals	
3-4 Proposed Improvements	
5 Details	

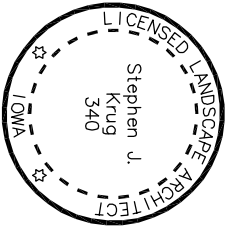

I hereby certify that this document was prepared by me or under my direct personal supervision and that I am a duly Licensed Landscape Architect under the laws of the State of Iowa.

Stephen J. Krug Iowa Reg No. 340
My License renewal date is June 30, 2018
Pages covered by this seal: _____

Cedar Rapids Parks & Recreation Department

This Document is Recommended for Filing with the
City Clerk

Director, Parks & Recreation Date

Demolition / General Notes

1. Before construction begins contractor shall call Iowa One Call 48-hours in advance of any work on the site. Any damage to existing utilities or structures shall be repaired by the contractor at the contractor's expense.
2. The contractor is responsible for obtaining any and all permits, inspections, and approvals required for the project.
3. The contractor shall install chain-link panels around the construction site with lockable gates to keep the area secure during construction.
4. The contractor shall remove and dispose of all excess materials from the site.
5. Sawcut around existing chain-link fence posts and remove all posts and chain-link fencing from ALL SIX (6) LOWER COURTS. Remove and dispose of.
6. Remove existing concrete sidewalk and entry concrete as shown on the plan.
7. Mill existing asphalt on south 3 tennis courts, full depth, and re-grade an compact as part of sub-base material.
8. Mill an additional strip 2.0 feet wide on south edge of the North 3 sets of courts. Mill 1-1/2 inches deep to allow for matching in the new asphalt from the south 3 courts.
9. Where concrete pad and or walkway are removed and no proposed proposed sidewalk will replace it, fill with topsoil that is free of rock and debris and seed with sunny mix per Cedar Rapids Metro Specifications.

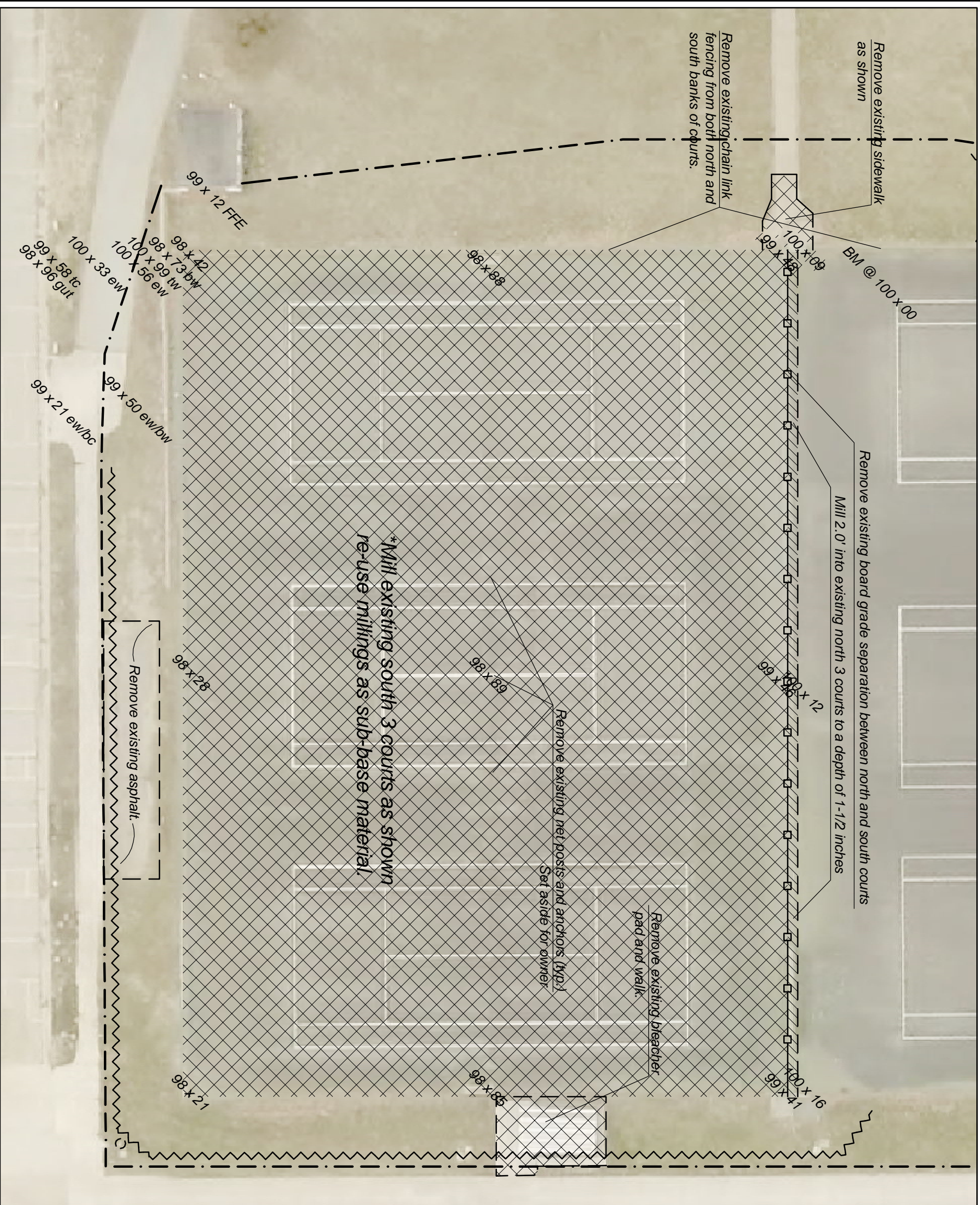

Legend

Existing / Proposed

Edge of Concrete

101.54 Spot Elevations

Chain link Fencing

Full depth milling, Ex. asphalt

1-1/2 inch depth milling, Ex. asphalt

Erosion Control Sock

North

Scale: 1" = 40'

Age Group	Percentage of Respondents
0'	~15%
20'	~45%
40'	~35%
80'	~5%

Veterans Memorial Tennis Center SE 3 Courts Reconstruction

Demolition / Removals

Demolition / General Notes

1. Before construction begins contractor shall call Iowa One Call 48-hours in advance of any work on the site. Any damage to existing utilities or structures shall be repaired by the contractor at the contractor's expense
2. The contractor is responsible for obtaining any and all permits, inspections, and approvals required for the project.
3. The contractor shall install chain-link panels around the construction site with lockable gates to keep the area secure during construction.
4. The contractor shall remove and dispose of all excess materials from the site.
5. Sawcut around existing chain-link fence posts and remove all posts and chain-link fencing from ALL SIX (6) LOWER COURTS. Remove and dispose of.
6. Remove existing concrete sidewalk and entry concrete as shown on the plan.
7. Mill existing asphalt on south 3 tennis courts, full depth, and re-grade an compact as part of sub-base material.
8. Mill an additional strip 2.0 feet wide on south edge of the North 3 sets of courts. Mill 1-1/2 inches deep to allow for matching in the new asphalt from the south 3 courts.
9. Where concrete pad and/or walkway are removed and no proposed proposed sidewalk will replace it, fill with topsoil that is free of rock and debris and seed with sunny mix per Cedar Rapids Metro Specifications.

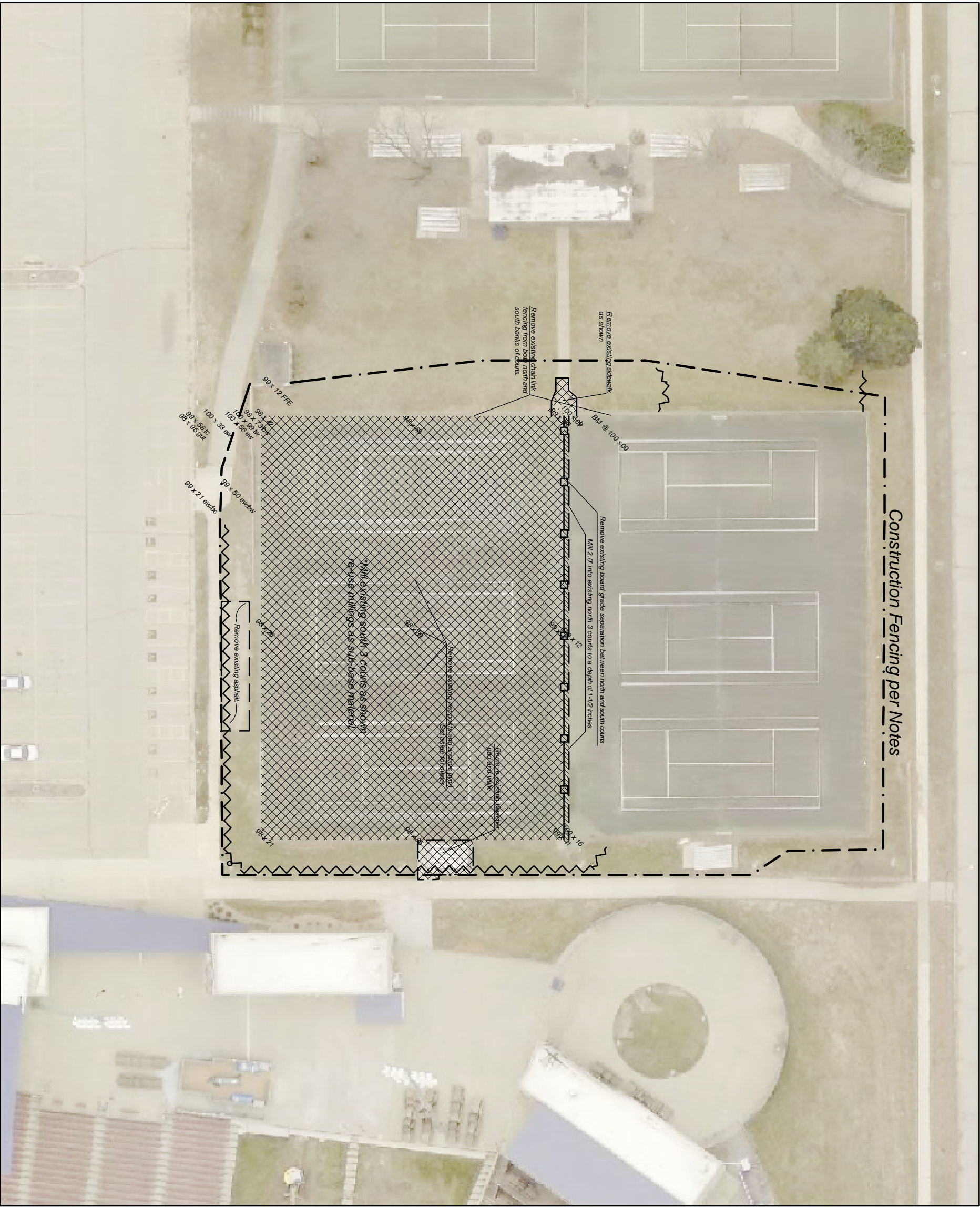

Legend

- | Existing / | Proposed | |
|---------------------------------------|----------|---------------------------------------|
| 10'x13' | 101.54 | Edge of Concrete Spot Elevations |
| Chain link Fencing | | Chain link Fencing |
| Full depth milling, Ex. asphalt | | Full depth milling, Ex. asphalt |
| 1-1/2 inch depth milling, Ex. asphalt | | 1-1/2 inch depth milling, Ex. asphalt |
| Erosion Control Sock | | Erosion Control Sock |



FILE NAME:	DRAWN BY:	APPROVED BY:	NO.	REVISION DESCRIPTION	APPROVED	DATE	CEDAR RAPIDS City of Two Seasons	Veterans Memorial Tennis Center SE 3 Courts Reconstruction	FILE NO: 311185	Demolition / Removals	SHEET NO. 2 OF 5
------------	-----------	--------------	-----	----------------------	----------	------	-------------------------------------	---	-----------------	-----------------------	---------------------

Construction / General Notes

1. Once Contractor has milled the south 3 courts he shall re-grade and compact the milled asphalt to use as sub-base material.
2. Contractor shall install additional 3" to 3-1/2" of imported asphalt milling; on top of existing milled asphalt sub-base. Additional sub-base asphalt millings shall closely match the existing millings on site.
3. Place 1/2-inch asphalt in two lifts with the final lift being a maximum of 2-inches thick. Base course to be 2" to 2-1/2" nominal thickness.
4. Place Petro Mat fabric across entire 3 courts and the additional 2' of the north courts on top of base / leveling course per manufacturer's specifications.
5. Asphalt for top surface course to be 1/2-inch asphalt. Place final lift of asphalt shifted over 1/2 width of previous asphalt course to help with a flat, level surface.
6. Surface course of asphalt shall be at a maximum of 1% slope from north to south. When complete contractor shall flood the courts to verify no ponding of water with a depth greater than 1/16 of an inch exists before the acrylic surfacing is placed.
7. If birdbaths over 1/16" exist on the newly paved courts the contractor shall use an acrylic leveling agent to fix these areas before final acrylic surfacing / striping is applied.
8. All proposed concrete pads and walkways shown on the plans are to be 4-inch PC Concrete placed on a compacted 4-inch granular sub-base. Sawcut per Metro Specifications.
9. Proposed chain link fencing to be 10.0' feet in height and shall be 9 gauge galvanized fence fabric.
10. Chain link fence shall have a 7 gauge bottom wire.
11. Fencing, posts, and all associated materials and work shall meet Cedar Rapids Metro Specifications.
12. Fence posts shall be sized to handle wind load with up to an 8.0' wind screen attached to the fence.
13. Install two (2) standard full height walk through swing gates where show on plans. Swing gates to be 5.0' wide, clear space between posts.
14. Install swing gates to swing as shown on plans.
15. Contractor shall remove sod as needed to allow for backfilling and drainage along reconstructed courts, fill with topsoil approved by owner Grade to per plans to match into existing drainage patterns on site.
16. Install 4-inch perforated drain tile as shown and connect to existing storm intake at SE corner of project as shown.
17. Install 4-inch double wall ADS storm sewer pipe as shown on plans at the entrance to the tennis courts for drainage.
18. For additional notes see the scope of work / specifications section of the bid documents. If there is a conflict between the plan set and the bid documents the most strict interpretation shall rule.

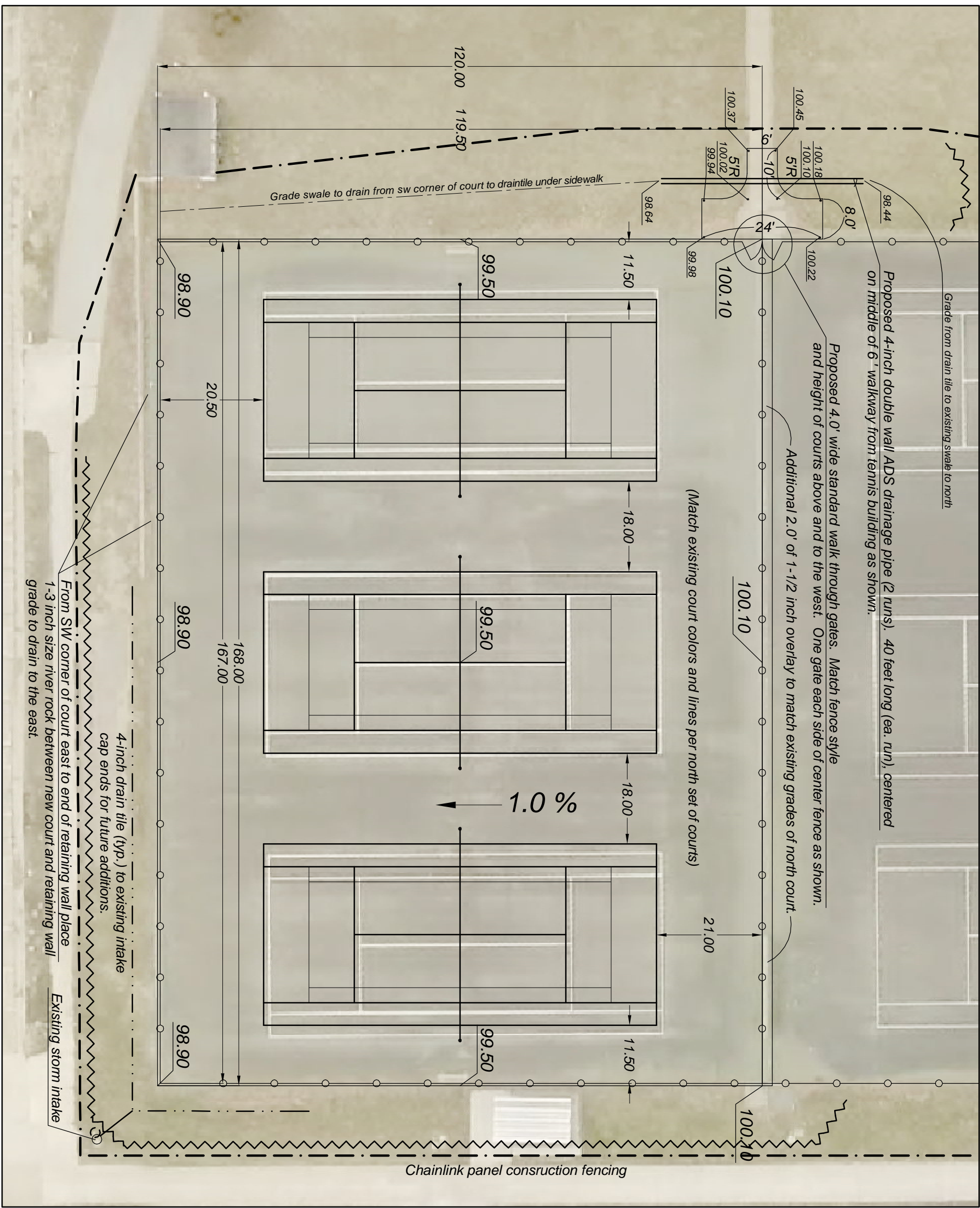

Construction Fencing per Notes

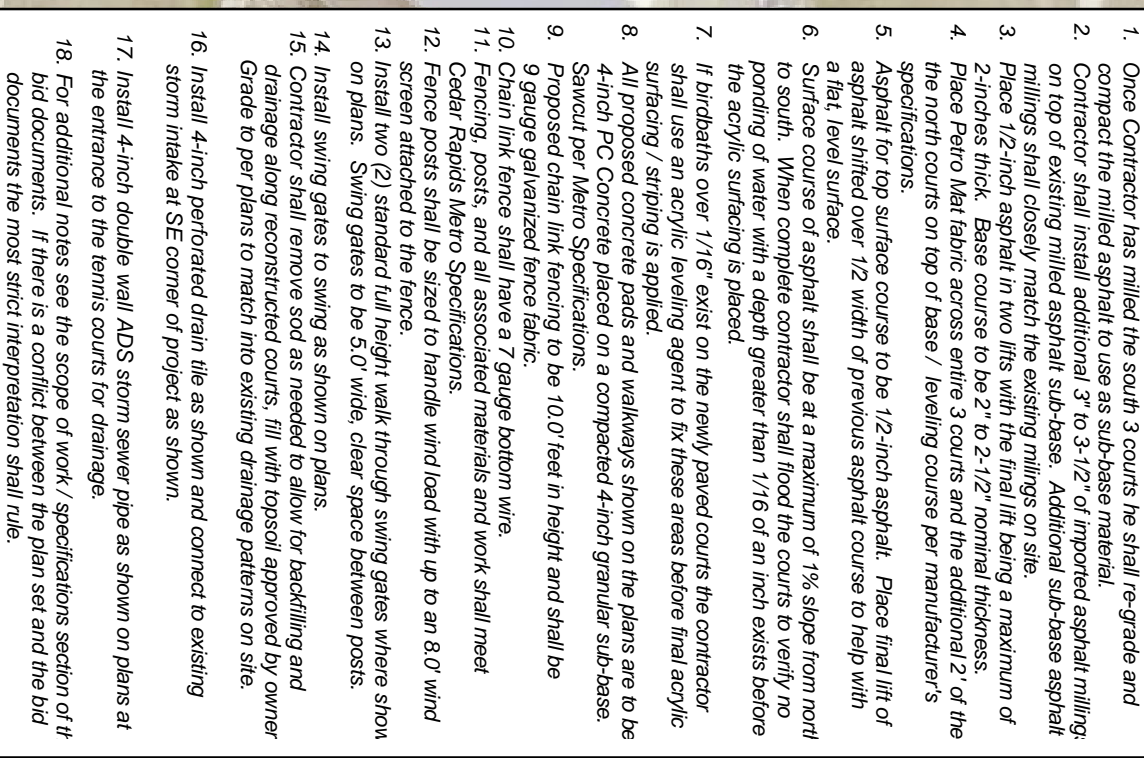

- | | | | |
|---------------------|--------|---------------------------------|---------------------------------------|
| Existing / Proposed | | | |
| 101x13 | 101.54 | | |
| | | Chain link Fencing | |
| | | Full depth milling, Ex. asphalt | 1-1/2 inch depth milling, Ex. asphalt |
| | | Erosion Control Sock | |

Scale: 1" = 40'

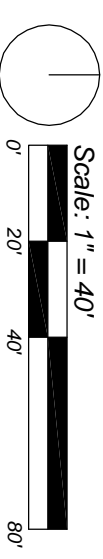

Tennis Court colors to match existing courts to the north.

Base lines shall be 4" wide, white
Playing lines shall be 2" wide, white

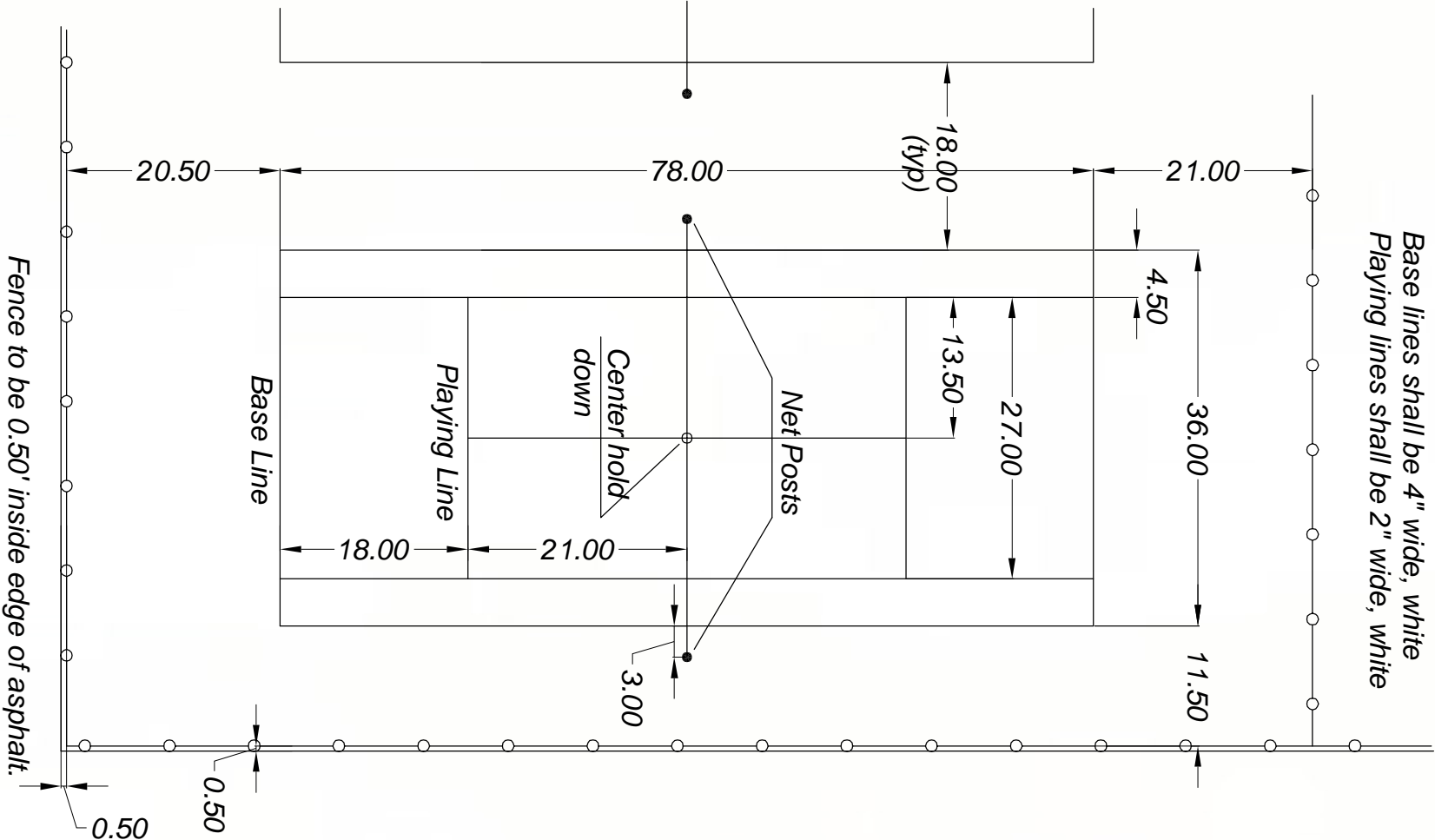

Typical Tennis Court Dimensions No Scale

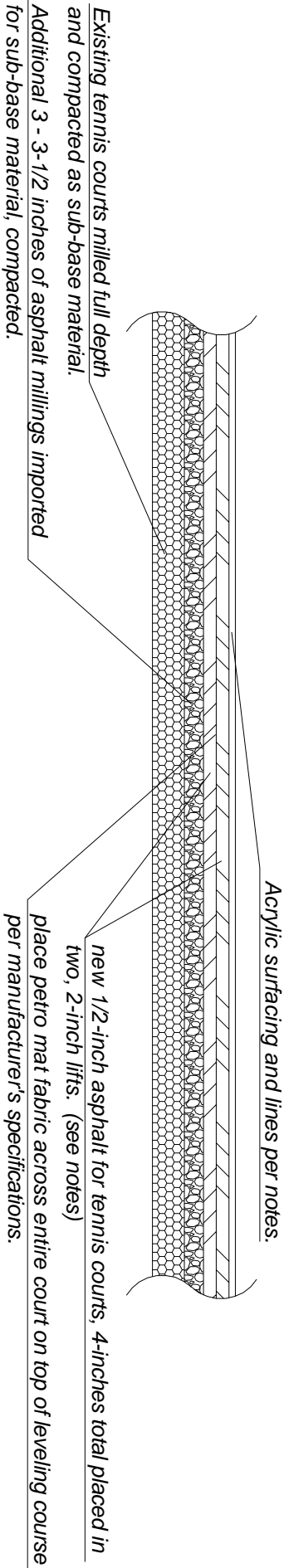

Tennis Court Detail

No Scale

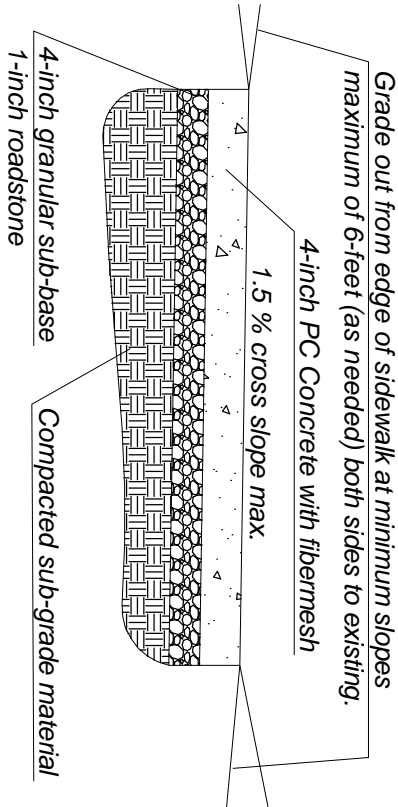

Typical Sidewalk Detail

No Scale